

Kensington

Electric Storage Water Heater

Bask In Happiness



Blue Enamel
Coated Tank



Blue Enamel
Coated Heating
Element



Kensington

Electric Storage Water Heater

Bask In Happiness

The Kensington aims to provide an enjoyable shower experience for the whole family. A robust and durable storage heating unit, the Kensington reliably takes care of everyone's shower needs, from young to old, generation to generation.



Giving the best we can through
knowledge and understanding
707.com.sg

A deep understanding of your needs means we have every detail carefully considered.



Blue Enamel Coated Tank

Superior quality steel tank with enamel protection for longer lifespan.



Thermal Insulation

Minimizes heat loss for great energy savings.



Blue Enamel Coated Heating Element

Our enamel coated incoloy element is highly resistance to corrosion and provides many years of durability.



IPX1 Splash Proof

Designed and built with splash-proof safety standard that protects the internal circuits from water.



Thermal Cutoff

Cuts off power supply when temperature reaches unsafe level.



Pledge of Safety

Tested repeatedly for safety and compliance with Singapore safety standards. We commit to keep you safe while giving you the luxurious shower experience.



Whirlflow 2 Technology

Ensures no immediate contact between hot and cold water for faster heating and further energy savings.



Multi-position Installation

Flexible Installation for your convenience.

For Right Hand Side Mounting

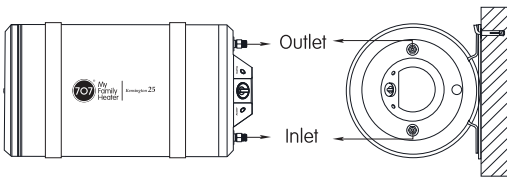

For Left Hand Side Mounting

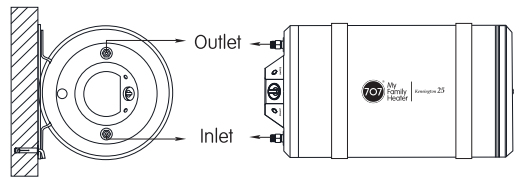

Technical Specifications

Model No.	Kensington 25
Capacity	25 Litres
Rated Voltage	230V~50Hz
Rated Power	3000W
Rated Pressure	0.8MPa
Inlet & Outlet Water Connection	1/2" BSP
Minimum Inlet Water Pressure	0.1MPa
Maximum Inlet Water Pressure	0.6MPa
Recommended Inlet Water Pressure	0.2MPa
Ingress Protection Rating	IPX1
Weight (Empty)	12.5kg
Dimensions (Ø X L)	380 x 515mm



Model No.	Kensington 35
Capacity	35 Litres
Rated Voltage	230V~50Hz
Rated Power	3000W
Rated Pressure	0.8MPa
Inlet & Outlet Water Connection	1/2" BSP
Minimum Inlet Water Pressure	0.1MPa
Maximum Inlet Water Pressure	0.6MPa
Recommended Inlet Water Pressure	0.2MPa
Ingress Protection Rating	IPX1
Weight (Empty)	15.4kg
Dimensions (Ø X L)	380 x 615mm



Cheong Hock Guan Water Heater Centre Pte Ltd

60 Paya Lebar Road, #04-17 Paya Lebar Square, Singapore 409051
 ☎ 6749 8885 ✉ mail@chg.com.sg 🌐 chg.com.sg 🌐 707.com.sg

📘 facebook.com/707myfamilyheater

Copyright © 2023 Cheong Hock Guan Water Heater Centre Pte Ltd.
 All rights reserved. Products and specifications may vary due to product improvement purpose.

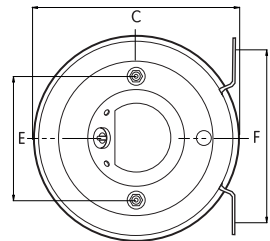
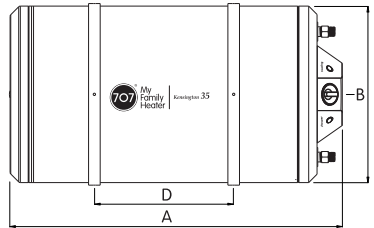

Dimension (mm)	Kensington 25	Kensington 35
A	515	615
B	Ø380	Ø380
C	405	405
D	260	260
E	270	270
F	265	265

Giving the best we can through
 knowledge and understanding
707.com.sg